

RV17-K4

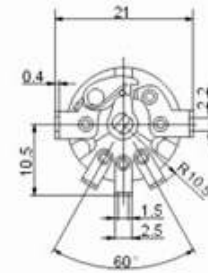
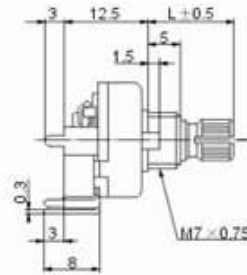
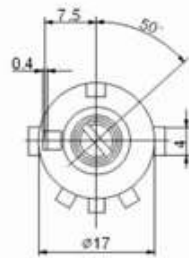

SHAFT SHOWN IN
FULL C.C.W POSITION

Mechanical characteristics: 机械性能

RV17系列

Total rotation angle 总旋转角度	$260^{\circ} \pm 5^{\circ}$
Rotation torque 旋转力矩	2~20mN.m(20~200gf.cm)
Shaft stop strength 止档强度	3 Kg f. Cm/min
Push pull strength 轴推拉强度	70N
Switch working angle/stroke 开关动作角度	$30^{\circ} \pm 10^{\circ}$
Switch operating torque 开关操作力	50~300gf.cm

Electrical characteristics: 电气性能

Total resistance 总阻值	5 K Ω ~2M Ω
Resistance taper 电阻规律	A、B、C
Resistance tolerance 阻值偏差	$\pm 20\%$
Rotational noise 转动噪音	$\leq 47\text{mV}$
Residual resistance 残留电阻	$R \geq 250 \text{ K}\Omega$ 0.1% max. of total resistance $250 \text{ K}\Omega > R > 10 \text{ K}\Omega$ 20 Ω max. $10 \text{ K}\Omega \geq R$ 10 Ω max.
Switch contact resistance 开关接触电阻	Less than 20m Ω
Rated wattage 额定功率	Curve B:0.125W Other curve B:0.063W
Max. operating voltage 最高使用电压	Curve B:200V Other than B:150V
Insulation resistance 绝缘电阻	More than 100M Ω at DC 500V
Dielectric 抗电强度	AC500V, 1 minute
Rating switching power 开关额定功率	12DC 1A

Mechanical life: 机械寿命

Mechanical life 机械寿命	10,000 cycles
Switch life 开关寿命	10,000 cycles